



Bethany Kempf



THE HARBOR at NOCATEE

THE HARBOR - WEST INDIES

4 Bedrooms • 3.5 Bathrooms • 2-Car Garage • 1,877 ft² Living Area • 2,431 ft² Under Roof

The Harbor floor plan is a 1,877-square-foot, four-bedroom, three and a half bath home that combines style and functionality. The two-story living room flows into a dining area and a modern kitchen, creating an open main floor. The main-level master suite offers a private retreat with a walk-in closet and en-suite bath. Upstairs, three bedrooms and a flexible retreat area provide additional space for family or guests, with a covered balcony for relaxation. With ICI Homes' customization options, you can personalize the Harbor to match your lifestyle, creating a home that feels truly yours.

Bethany Kempf

ICI Homes -

bkempf@icihomes.com

* Renderings may vary from actual home. Please see disclaimer for more details.

THE HARBOR

4 Bedrooms • 3.5 Bathrooms • 2-Car Garage

Nocatee
Ponte Vedra, FL

Available In
West End Townhomes

Living Area: 1,877 ft² **Under Roof:** 2,431 ft²

THE FARMHOUSE

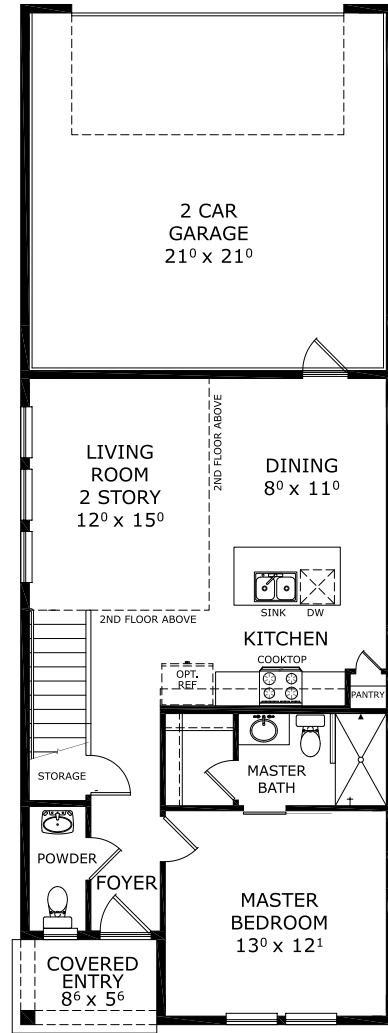

COPYRIGHT

FIRST-SECOND FLOOR

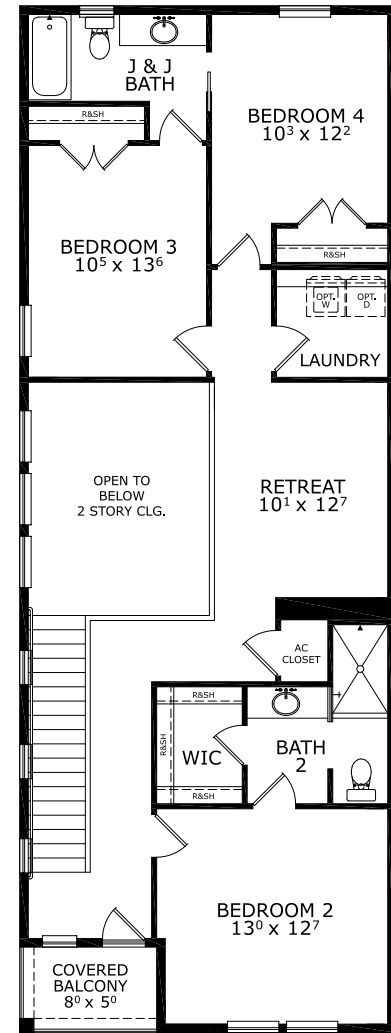

COPYRIGHT

©1994-2026 ICI Homes™ is a registered trademark whose divisions operate under CBC1267313, CBC1262114, CBC1262120, CBC1264300, CBC1265743, CRC1333091, and CBC1257263. Features may be plan specific and vary. Please consult a Sales Associate for specific feature information. All new ICI Homes come with a HBW 2-10 warranty. Certain elevations may have additional fees. Prices may not include lot premiums, upgrades, and options. Inventory home completion date may vary. All prices subject to change without notice. All plans are property of ICI Homes and cannot be copied or used without permission. Prices, promotions, incentives, features, options, amenities, floor plans, elevations, site maps, designs, materials, and dimensions are for illustrative purposes only and subject to change without notice. Plans should not be relied upon as representation express or implied of final sizes, locations, features or dimensions. Square footage and dimensions are estimated and may vary from description. All HERS ratings and savings are calculated by a third party energy rating service. Actual savings will depend on a number of factors, including but not limited to daily activities, home maintenance practices, household size, use of appliances, lighting and internal climate control systems, lot orientation, and surrounding climate and weather conditions. Created on 04/05/2026: _____ Garage Orientation R / L: _____

